

Standard LED light bars

ST standard light bars are thin, lightweight and come with **3M adhesion** for easy attachment to shelves of almost any material. For additional hold, you can add cable clips.

ST, our simplest and most attractively priced model, provides ideal **shelf lighting in straight lines along the front of the display**. ST light bars are available in a variety of lengths ranging from 120mm to 840mm.

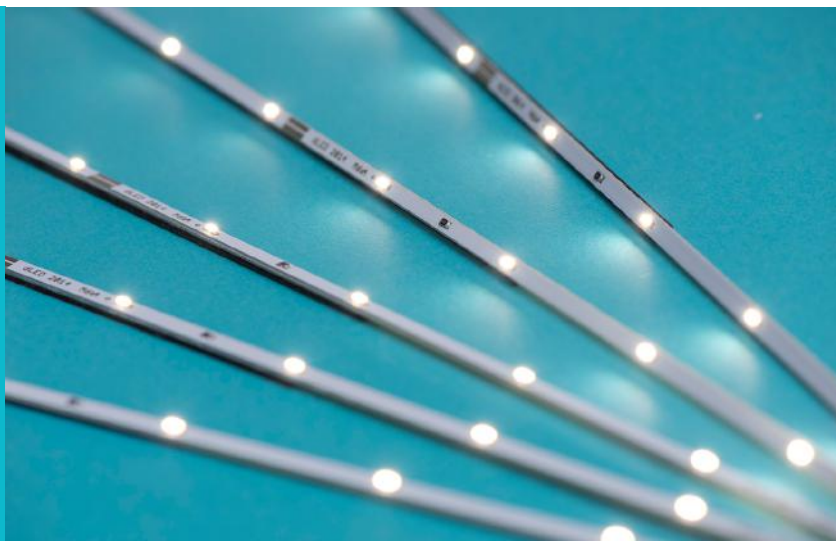

APPLICATION

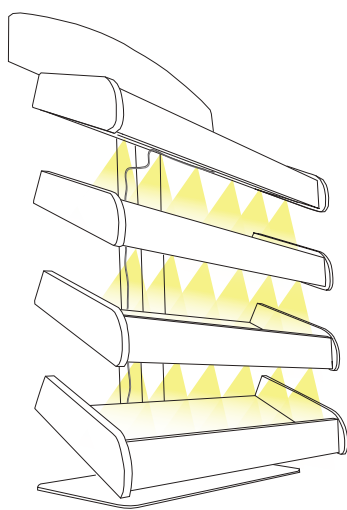

ONE POLE DISPLAYS

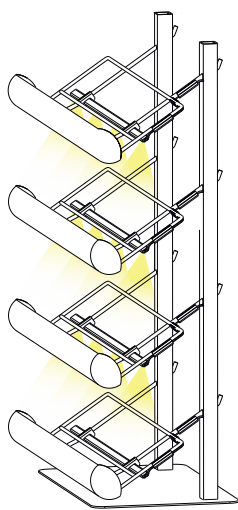

TWO POLE DISPLAYS

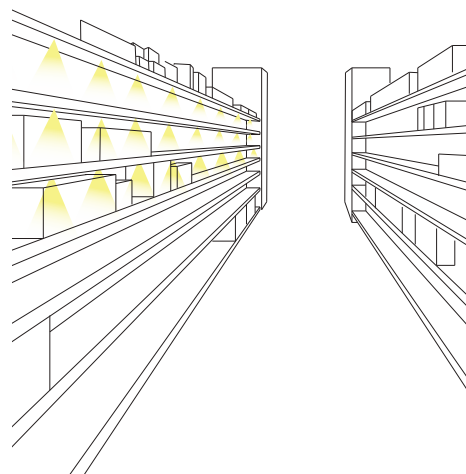

SHELVES

LIGHT BAR

cable entry on the side

A

length of bar and number of LEDs varies

power in

power out for next strip

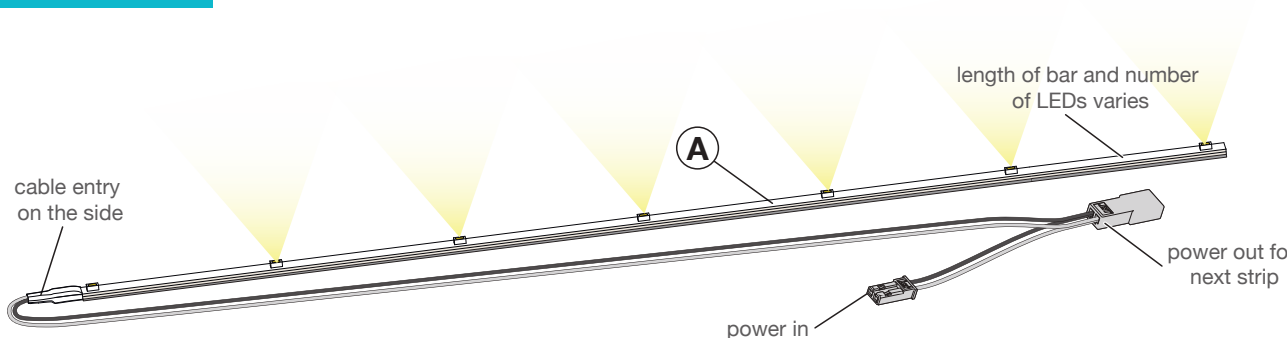

DETAILS

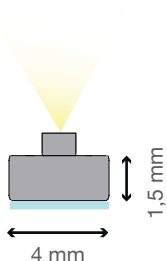

CROSS SECTION

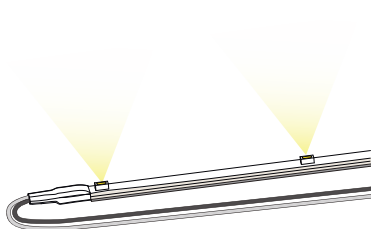

CABLE ENTRY - SIDE

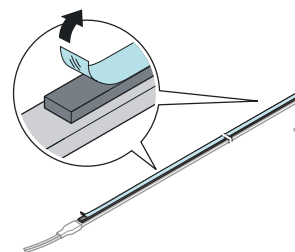

ATTACHMENT WITH 3M ADHESION

SELECTED ACCESSORIES

Power plugs available for US, UK and EU standard sockets

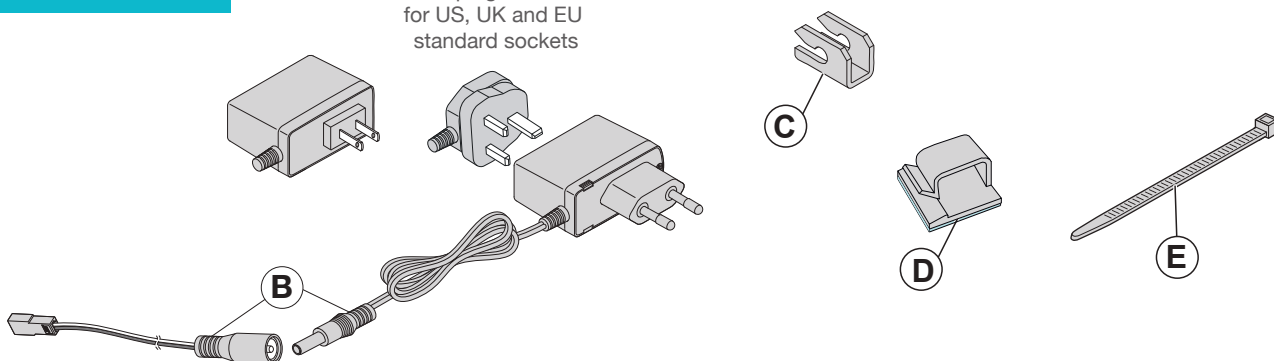

TABLE

	TYPE	 mm	V	K	W max.	T_A
	500204 Y-SYSTEMST:main120	120	13 V	4000 K	0.4 W	0 °C – 40 °C 32 °F – 109 °F
	500206 Y-SYSTEMST:main260	260			0.7 W	
(A)	500210 Y-SYSTEMST:main410	410			1.1 W	
	500230 Y-SYSTEMST:main550	550			1.1 W	
	500240 Y-SYSTEMST:main740	740			1.4 W	
	500250 Y-SYSTEMST:main840	840			1.8 W	
(B)	500100 Y-SYSTEM:plug & power cable UK		13 V		12 W	
	500101 Y-SYSTEM:plug & power cable EU			12 W		
	500102 Y-SYSTEM:plug & power cable US			12 W		
(C)	500704 Y-SYSTEM:clip for wired shelves					
(D)	500741 Y-SYSTEM:cable clip with adhesive tape					
(E)	500701 Y-SYSTEM:cable tie	100				

Any questions?

Please don't hesitate to contact us. We will be pleased to help you choose the right lighting and accessories to put your merchandise in the best light.

Give us a call:

fon: +49-89-4141-7-007-0
cell: +49-171-19-888-11

Send us an email:

hello@dled.eu