

XD+ LED bars with protective covering

For additional stability and protection from direct contact with the LEDs that can occur when stocking the shelves or taking out merchandise, choose XD+ light bars, which are based on our ST model, but are **housed in a sturdy plastic casing**.

XD+ light bars come with 3M adhesion for easy installation on shelves of nearly any material.



APPLICATION

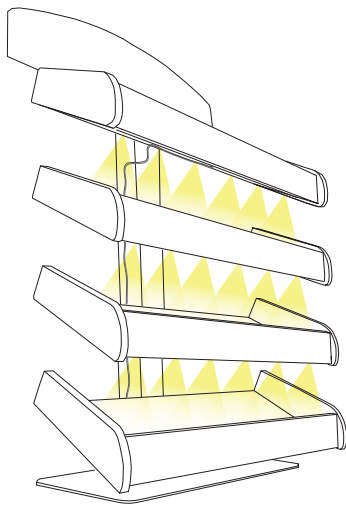

ONE POLE DISPLAYS

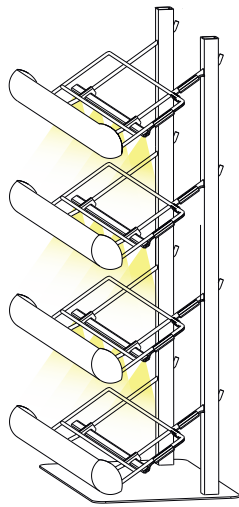

TWO POLE DISPLAYS



SHELVES

LIGHT BAR

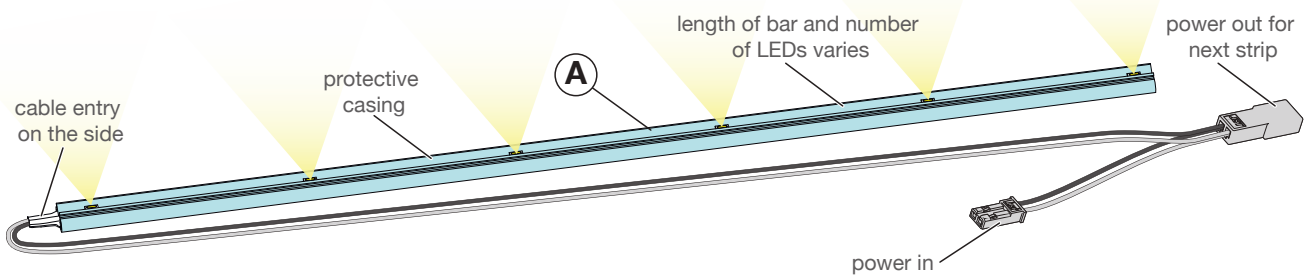

02/2017

DETAILS

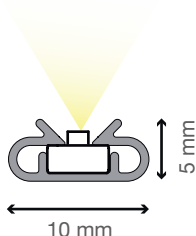

CROSS SECTION PROTECTIVE CASING

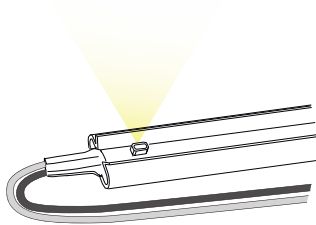

CABLE ENTRY - SIDE

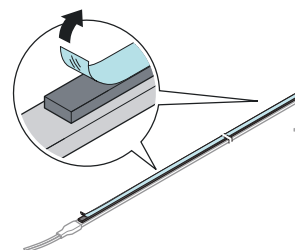

ATTACHMENT WITH 3M ADHESION

SELECTED ACCESSORIES

Power plugs available for US, UK and EU standard sockets

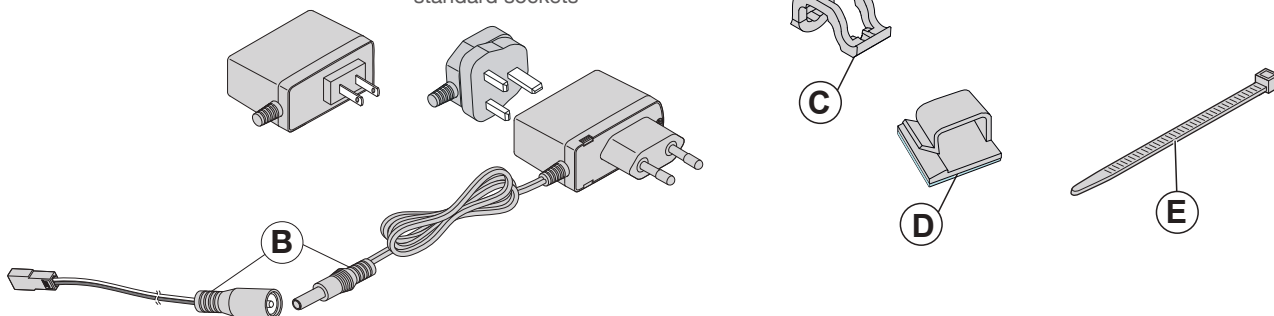

TABLE

	TYPE	mm	V	K	W _{max.}	T _A
	500208 Y-SYSTEMXD+:main260	260	13 V	4000 K	0.7 W	0 °C - 40 °C 32 °F - 109 °F
	500212 Y-SYSTEMXD+:main410	410			1.1 W	
(A)	500232 Y-SYSTEMXD+:main550	550			1.1 W	
	500242 Y-SYSTEMXD+:main740	740			1.4 W	
	500252 Y-SYSTEMXD+:main840	840			1.8 W	
(B)	500100 Y-SYSTEM:plug & power cable UK		13 V		12 W	
	500101 Y-SYSTEM:plug & power cable EU			12 W		
	500102 Y-SYSTEM:plug & power cable US			12 W		
(C)	500724 Y-SYSTEMXD+:clip for wired shelves					
(D)	500741 Y-SYSTEM:cable clip with adhesive tape					
(E)	500701 Y-SYSTEM:cable tie	100				

Any questions?

Please don't hesitate to contact us. We will be pleased to help you choose the right lighting and accessories to put your merchandise in the best light.

Give us a call:

fon: +49-89-4141-7-007-0
cell: +49-171-19-888-11

Send us an email:

hello@dled.eu